

MODEL 100 WINCH PARTS KING WINCH

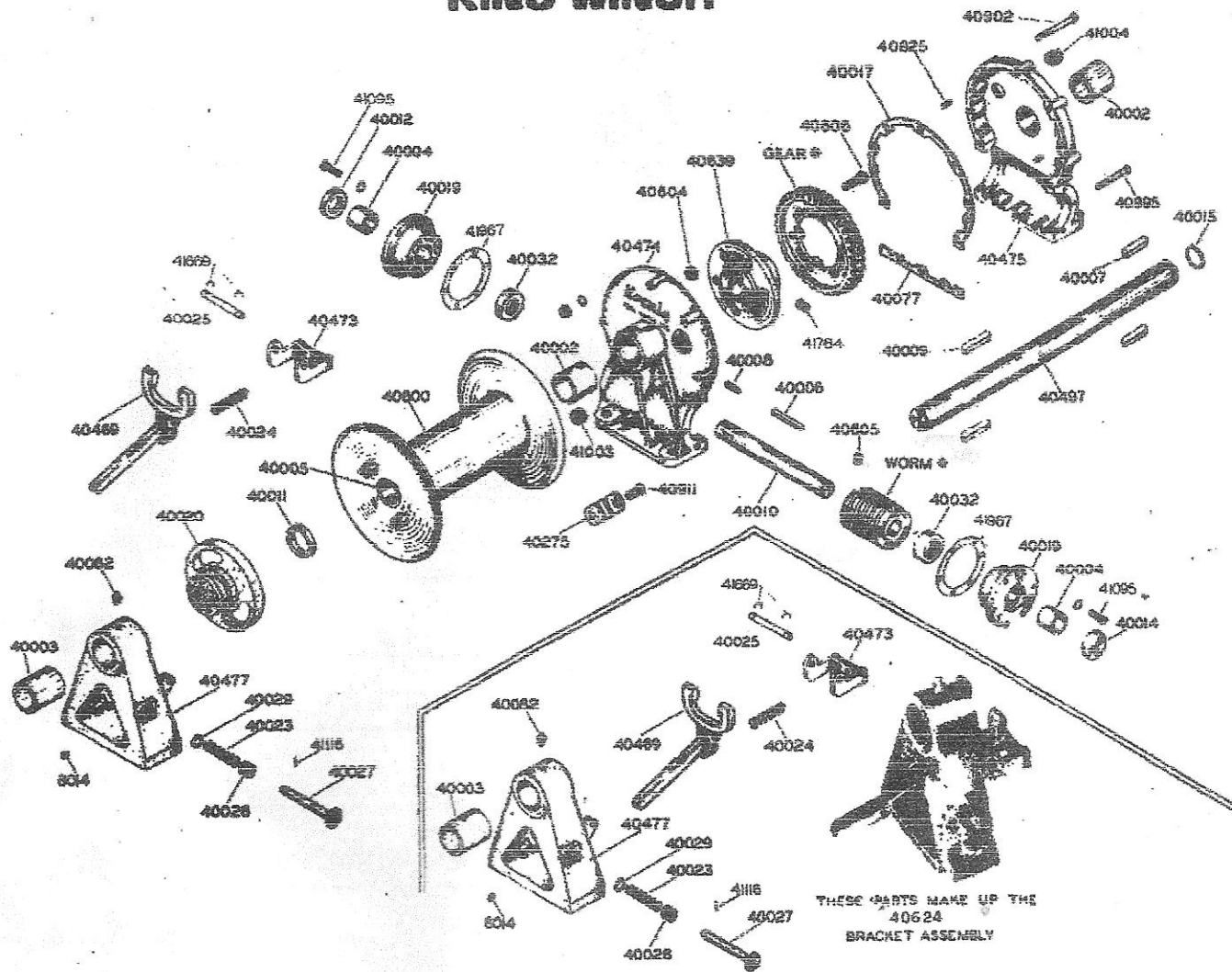

Part No.	Description	Part No.	Description	Part No.	Description
7843	Nut (7 req'd)	40026	Bushing	40477	Bracket, w/bushing
8014	Set screw	40027	Pin	40497	Drum shaft w/keys
40002	Bushing (2 req'd)	40629	Washer	40600	Drum w/bushing
40003	Bushing	40632	Bearing (2 req'd)	40604	Locknut (6 req'd)
40004	Bushing (2 req'd)	*40033	Worm, 36:1 RH	40605	Set screw
40005	Bushing (2 req'd)	*40034	Worm, 36:1 LH	40606	Bolt (6 req'd)
40006	Worm key	*40064	Worm, 9:1 RH	40624	Bracket assy.
40007	Spider key (2 req'd)	*40065	Worm, 9:1 LH	40625	Bowl pin (2 req'd)
40008	Worm key	*40066	Worm, 18:1 RH	*40617	Gear, 36:1 RH
40009	Clutch key (2 req'd)	*40067	Worm, 18:1 LH	*40618	Gear, 36:1 LH
40010	Wormshaft w/keys	*40679	Gear, 18:1 LH	40619	Spider
40011	Set collar	*40071	Gear, 18:1 RH	40902	Bolt, (7 req'd)
40012	Oil seal	*40072	Gear, 9:1 LH	40911	Bolt (2 req'd)
40014	Plug	*40073	Gear, 9:1 RH	40995	Socket cap screw (3 req'd)
40015	"O" ring	40077	Gasket	41003	Counter sunk grease plug
40017	Gasket	40082	Zerk fitting	41004	Square head grease plug
40019	Bearing holder, w/bushing (2 req'd)	40275	Cable clamp	41095	Bolt (12 req'd)
40020	Drum clutch	40469	Shifter lever	41116	Pin for 40027
40023	Spring	40473	Brake shoe	41669	Retaining "O" ring (2 req'd)
40026	Spring	40474	Housing half w/bushing, stepped	41764	Set screw
40025	Pin	40475	Housing half w/bushing	41967	Gasket (2 req'd)