

KOENIG MODEL 10 CENTER POWER TAKE-OFF FOR ALL MODEL JEEPS

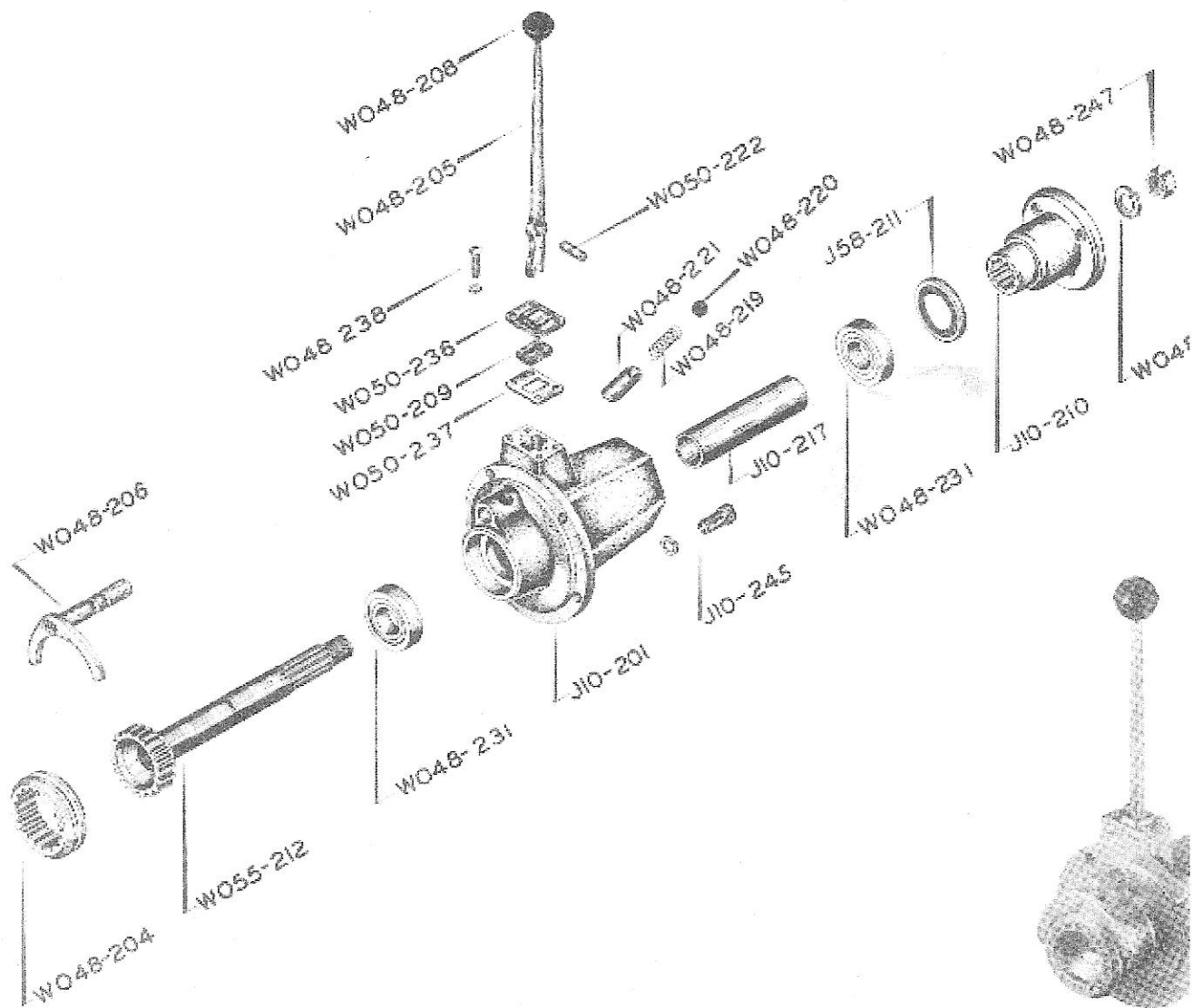

PART NO.	DESCRIPTION
J10-201	Housing
WO48-204	Sliding ring
WO48-205	Lever
WO48-206	Shifter to engine
WO48-208	Knob
WO50-209	Felt oil retainer for lever
J10-210	Coupling
J58-211	Oil seal 2 1/4" OD x 1 9/16" ID x 1/4"
WO55-212	Main P.T.O. shaft
J10-217	Bearing spicer
WO48-218	Gasket between P.T.O. and transmission

PART NO.	DESCRIPTION
WO48-219	Spring
WO48-220	Ball
WO48-221	Bushing for shifter ball and Pin
WO50-222	Pin
WO48-231	Ball bearing 1" ID (2 req.)
WO50-236	Top shifter plate
WO50-237	Bottom shifter plate
WO48-238	Shifter-plate screw and wash
J10-245	Cap screw 3/8" NC x 1" (5 req)
WO48-246	Lock washer
WO48-247	Hex nut 3/8" NF