

LEFT HAND MOUNT

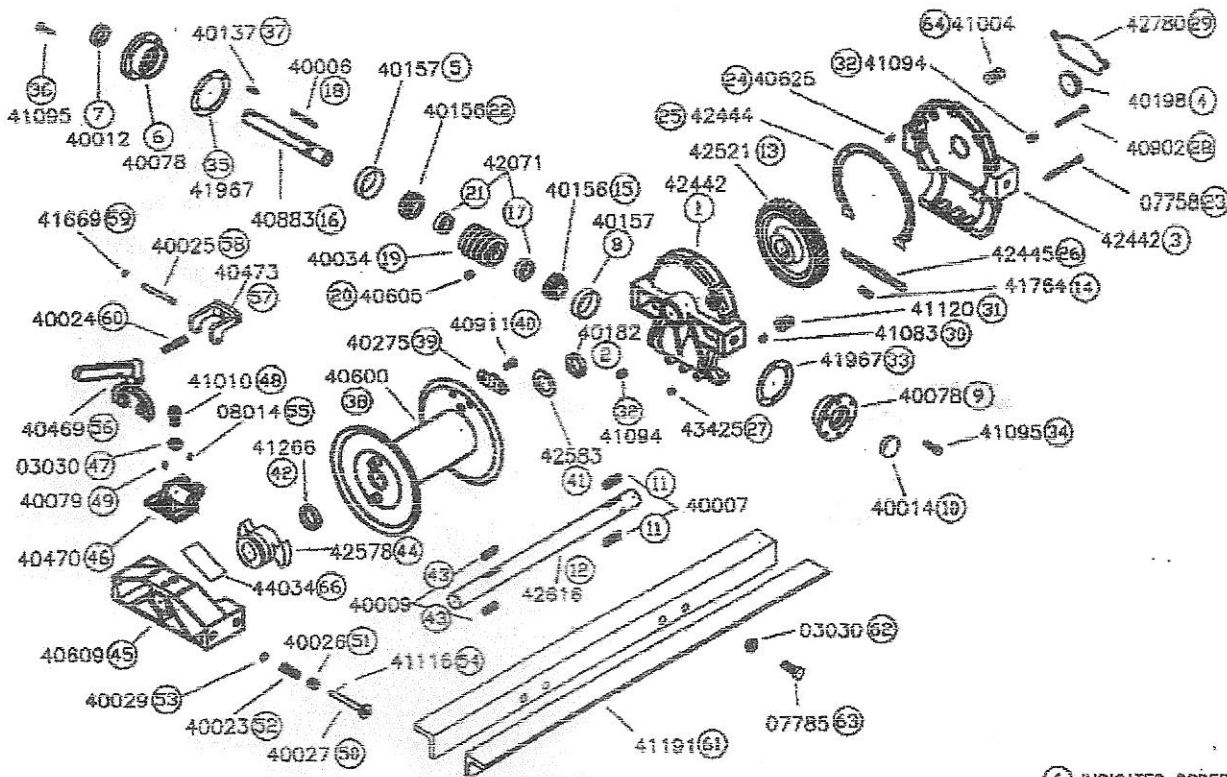

① INDICATES ORDER OF ASSEMBLY

PART NO.	QTY	DESCRIPTION	PART NO.	QTY	DESCRIPTION
03030	9	Washer - Lock .500"	40609	1	Bracket w/40003 Bushing*
07758	3	Screw - Cap Hex Hd. .250" x 3.500"	40625	2	Pin - Dowel
07785	8	Screw - Cap Hex Hd. .500" x 1.250"	40883	1	Shaft - Worm
08014	1	Screw - Set Skt. .250" x .250"	40902	7	Screw - Cap Hex Hd. .250" x 2.750"
40006	1	Key - Worm	40911	2	Screw - Cap Hex Hd. .375" x .875"
40007	2	Key - Gear	41004	1	Pipe Plug - .500"
40009	2	Key - Clutch	41010	1	Screw - Ferry Head .500" x .875"
40012	1	Oil Seal	41083	1	Relief Valve
40014	1	Plug	41094	2	Pipe Plug - .125"
40023	1	Spring - Compression	41095	12	Screw - Cap Hex Hd. .250" x 1.000"
40024	1	Spring - Compression	41116	1	Pin - Roll
40025	1	Pin	41120	1	Pipe Reducer - .500" to .125"
40026	1	Bushing	41191	2	Mounting Angles
40027	1	Pin - Shifter	41266	1	Spacer - Drumshaft
40029	1	Washer	41669	2	Retaining Ring
40034	1	Worm - 36:1 Left Hand	41764	1	Screw - Set Skt. .375" x .625"
40078	2	Bearing Holder	41967	4 or 6	Gasket - Bearing Holder
40079	1	Grease Fitting	42071	2	Spacer - Worm
40137	1	Key - Input	42442	2	Housing w/42587 Bushing*
40156	2	Bearing Cone	42444	1	Gasket - Housing Top
40157	2	Bearing Cup	42445	1	Gasket - Housing Bottom
40182	1	Oil Seal	42521	1	Gear - 36:1 Left Hand
40198	1	Plug	42576	1	Clutch - Drum
40275	1	Cable Clamp	42583	1	Washer - Thrust
40469	1	Shifter Lever	42616	1	Shaft - Drum
40470	1	Bracket - Shifter	42780	1	Data Plate
40473	1	Brakeshoe Assembly	43425	10	Nut - Lock .250"
40600	1	Drum w/40006 Bushing*	44034	1	Label - Clutch Engage
40605	1	Screw - Set Skt. .375" x .375"			

*NOTE: BUSHINGS AND PINS CAN BE ORDERED SEPARATELY